

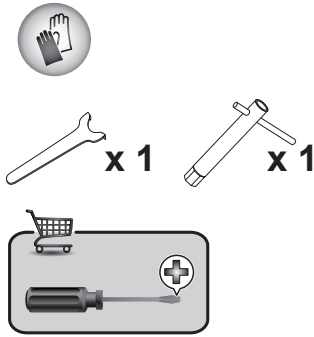

# ADDENDUM EMS1221RG

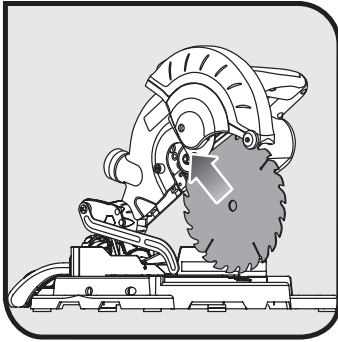

## INSTALLING THE BLADE

Follow the steps below to install the blade.

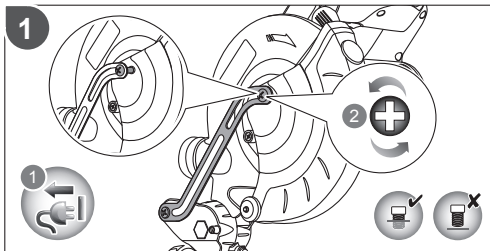

1. Loosen the arm screw from the blade guard. Do not remove the screw from the arm.

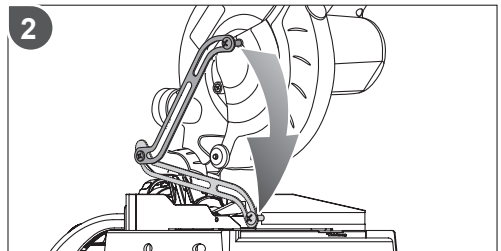

2. Lower the arm and rest it on the turntable.

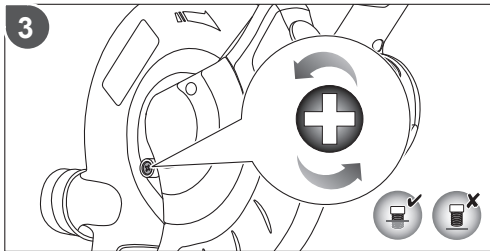

3. Loosen, but do not remove the screw on the lower guard.

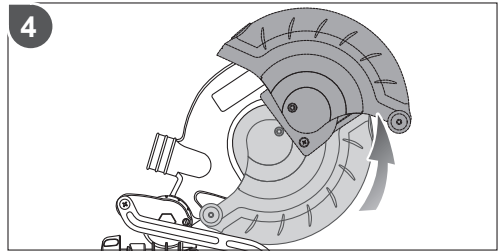

4. Swing the lower guard upward and hold it.

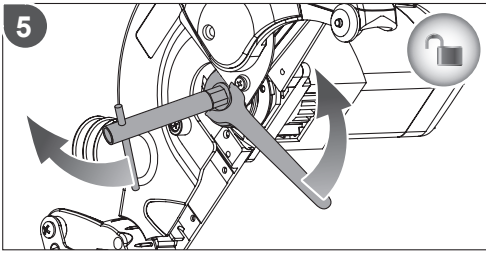

5. Place the pin wrench on the outer flange and at the same time place the tube wrench on the blade screw. Rotate the tube wrench clockwise to loosen the blade screw.

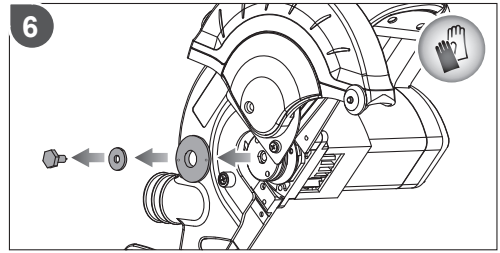

6. Remove the blade screw, washer and outer flange.

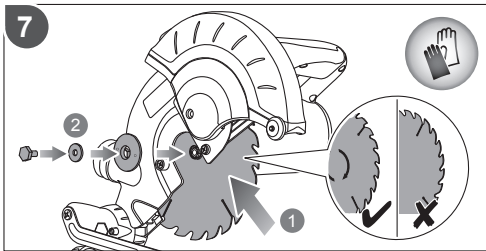

7. Install the new blade onto the inner flange, paying attention to the blade teeth direction. Place the outer flange, washer and blade screw.

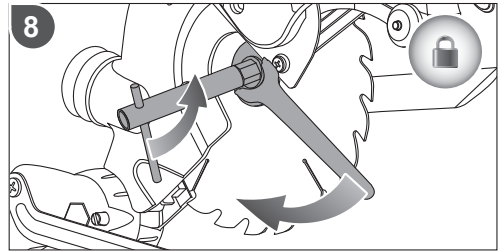

8. Place the pin wrench on the outer flange and at the same time place the tube wrench on the blade screw. Rotate the tube wrench counterclockwise to tighten the blade screw.

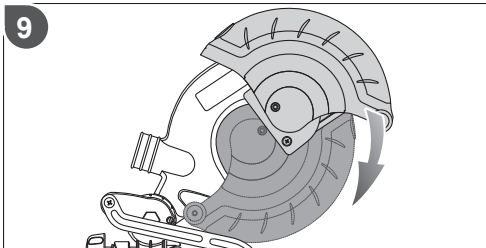

9. Lower the lower guard.

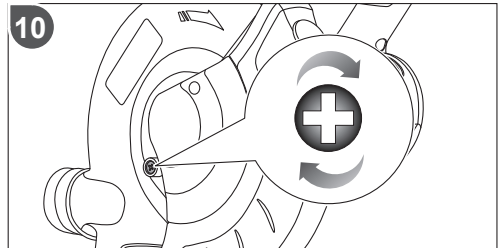

10. Tighten the screw on the lower guard.

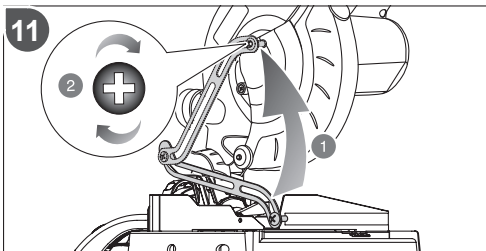

11. Return the arm to the upper position. Tighten the screw.