

# BOSTON®

GREAT VALUE SOLUTIONS



## BURST ALERT® DUAL LAYER 2 X 2 METRE INLET HOSES FOR WASHING MACHINES

### TWIN PACK

Dual layer protection for your home. The external transparent barrier turns red or blue to display the presence of water if the internal hose leaks, whilst protecting your home from flooding. The Burst Alert® hose allows you to finish your wash cycle even after recognising the internal failure.

**Important: Check hose colour regularly. If internal leak occurs, replace hose immediately after the washing cycle finishes.**



#### DUAL LAYER PROTECTION

DURABLE PVC INNER HOSE RATED TO  
2100kPa/300PSI & UP TO 90°C (RED),  
1000kPa/145PSI & UP TO 25°C (BLUE)

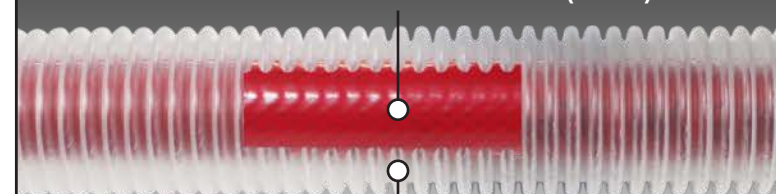

IN CASE OF A BURST, THE OUTER HOSE TRAPS WATER  
& PROTECTS YOUR HOME FROM FLOODING

#### INSTALLATION INSTRUCTIONS

- Turn off water supply & remove old hoses.
- Clean all connecting threads.
- Attach new **RED** hose to the hot water tap & the **BLUE** hose to the cold water tap. Attach curved ends to appliance. Hand tighten nuts **ONLY**; do not use tools to tighten nuts.
- Turn water on – check for leaks.
- If the hose is connected to a hot or cold water line where the pressure exceeds 500kPa (72.5psi), then a pressure limiting valve set at 500kPa (72.5psi) should be installed.
- Do not connect either hose to a hot water service unit.

#### TECHNICAL SPECIFICATIONS

- Operating temperature: Up to 90°C for the red hose & up to 25°C for the blue hose.
- Operating pressure: 2100kPa (300psi) red hose. 1000kPa (145psi) blue hose.
- 3/4" BSP nut & tail.

#### IMPORTANT INFORMATION

- Do not overtighten nuts.
- It is recommended that all appliance hoses be replaced every five years.
- To protect your hose, it is recommended that taps are fully turned off after using your washing machine.
- It is recommended that this product be installed by a licensed plumber.
- It is strongly recommended that this product is not joined to create a longer length.
- If used on nylon threads, ensure no cross-threading takes place.
- Not for use where hose will be hidden behind appliance or in cupboards as hose colour should be checked regularly. Replace hose immediately if internal leak occurs.
- Do not stretch, twist or kink the hose.
- Do not allow the hose to curve near the water entry end, as this may cause a pressure point.

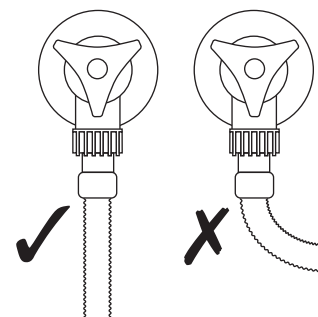

#### FIVE YEAR WARRANTY

This warranty runs for five (5) years from the date of purchase. Our products come with guarantees that cannot be excluded under the Australian Consumer Law. You are entitled to a replacement or refund for a major failure & for compensation for any other loss or damage. You are also entitled to have the goods repaired if the goods fail to be of acceptable quality & the failure does not amount to a major failure.

#### WHAT IS COVERED

The installation instructions & important information form part of this warranty. This warranty covers any defects in materials or workmanship with the exception of the reasons stated below. The warranty covers the product for normal domestic use only.

#### WHAT IS NOT COVERED

This warranty does not cover wear & tear to working parts, misuse or abuse. It does not cover discolourations or damage due to exposure to sunlight or cleaning chemicals. Failure to follow the installation instructions or important information may void the warranty.

#### CLAIM PROCEDURE

If you believe you have a legitimate claim with your BOSTON® hose please contact FIX-A-TAP® Australia via our website at [www.fixatap.com.au/warranty](http://www.fixatap.com.au/warranty) to complete the warranty claim form. Alternatively you can contact our office on (02) 9476 7400.

Any written correspondence should be sent to: FIX-A-TAP® Australia, PO Box 200, Wahroonga, NSW 2076. Please keep your receipt for proof of purchase.

**FIX-A-TAP®**  
AUSTRALIA PTY LTD  
The Ultimate Plumbing Solution  
PO Box 200 Wahroonga  
NSW Australia 2076  
Made in Turkey ©2025  
[www.fixatap.com.au](http://www.fixatap.com.au)  
Visit our website  
for socials, plumbers,  
product info & more



A family  
owned  
Australian  
business

**Quality Assured Products**  
FIX-A-TAP® has been providing  
Australians with quality plumbing  
products since 1972.

#### PlumbConnect® Plumbers Registry

We recommend installation by a licensed plumber. To find a plumber in your area consult our Plumbers Registry with this QR code:

