

ROLLTRAK

EASY OPEN / HOLD DOOR CLOSER

DOOR & WINDOW SPECIALISTS

Model Number:

R3580, R3581, R3582 & R3583

Tools required:

Drill, pencil, phillips head and flat-headed screwdriver, pliers and 4mm drill bit.

Contents:

- 1 x Door closer & rod
- 1 x Jamb bracket
- 1 x Split pin
- 3 x 25mm x 10g self-tappers
- 2 x 19mm x 10g self-tappers
- 1 x Spacer / adjustment tool
- 1 x Stop washer

Step 1:

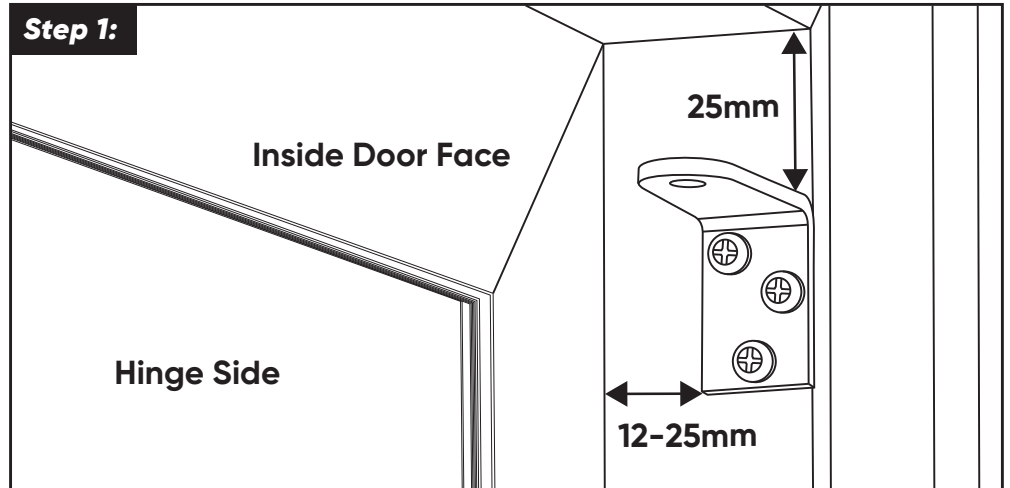

Hold the jamb bracket against the door frame, about 12mm (approx. 1/2") from the edge and 25mm (approx. 1") from the top of the door frame. Mark the screw holes with a pencil. Use a 4mm (5/32") drill bit to drill the holes and the enclosed 25mm screws to attach the bracket.

Step 2:

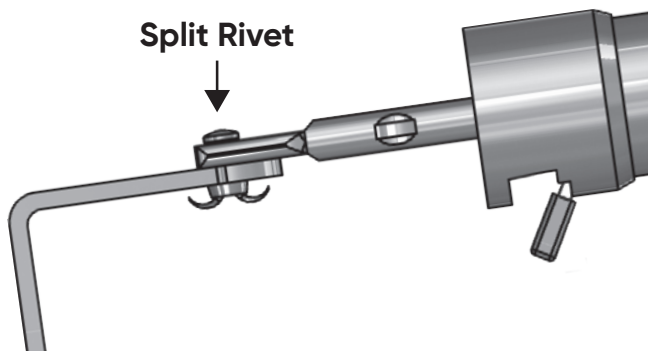

Place the stop washer over the rod, pull out the rod and insert spacer tool. Fit rod onto the jamb bracket and insert the split pin. Do not deform the pin. Do not remove the spacer tool yet.

Step 3:

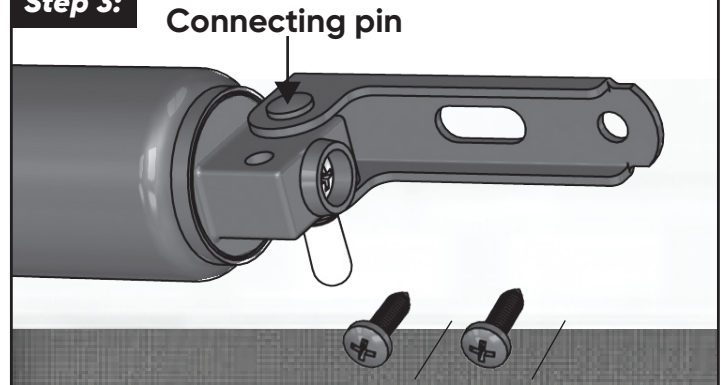

Connect the door bracket to the other end of the door closer using the connecting pin. To tension the unit, pull the cylinder out 15mm (1/2") and press the hold-open catch. Hold the bracket against the closed door, and ensuring the door closer is level, mark the holes and drill two pilot holes. Fasten the bracket to the door using the enclosed, short screws.

Step 4:

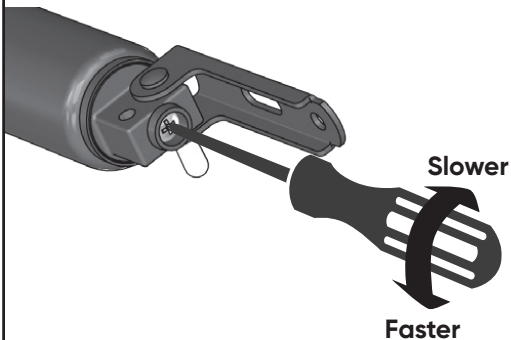

Adjust the closing speed. Turn clockwise to slow down and anti-clockwise to speed up. It may be necessary, within a week or so, to readjust the closing speed after the unit has settled in.

Holding The Door Open & Closing The Door:

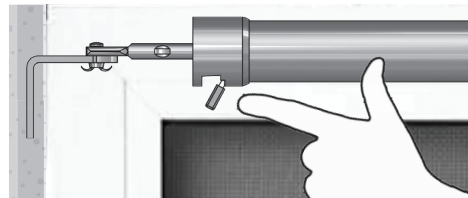

Use one hand to hold the door at the required opening. Use the other hand to press the hold-open catch. Whilst continuing to press the catch release the door.

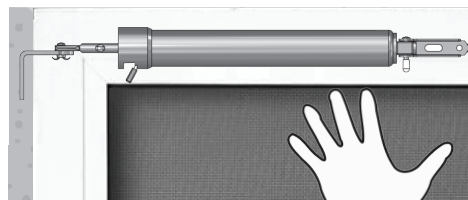

Push the door open slightly. The door will unlatch from the hold-open catch and close automatically.