

# ROLLTRAK

## HEAVY DUTY DOOR CLOSER - BLACK

DOOR & WINDOW SPECIALISTS

Model Number:

R3570BLK

Tools required:

Drill, tape measure, pencil, phillips head and flat-headed screwdriver, pliers and 3.2mm drill bit.

### Contents:

- 1 x Door closer with sliding hold-open washer
- 1 x Door bracket & pin with cap
- 1 x Jamb bracket
- 1 x Split rivet
- 3 x Long self-tapping screws
- 2 x Short self-drilling screws

### Step 1:

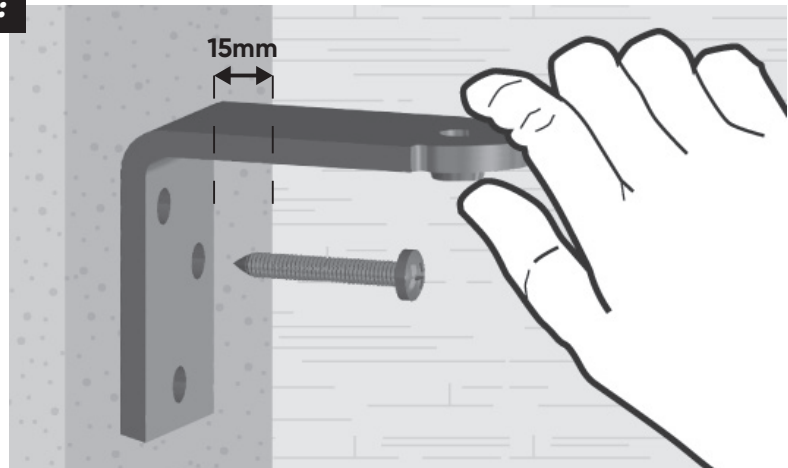

Hold the jamb bracket against the door frame, about 15mm (5/8") from the edge and 25mm (1") from the top of the door frame. Mark the screw holes with a pencil. Use a 3.2mm (1/8") drill bit to drill the holes. Use the enclosed 25mm screws to attach the bracket.

### Step 2:

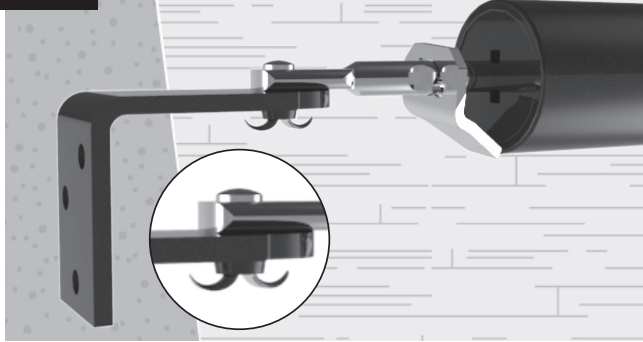

Connect the door closer to the jamb bracket using the split rivet. Spread the split rivet's tail with a flat-head screwdriver. For strongest results, roll the tails with pliers, to resemble the diagram. To pre-tension the unit, pull the cylinder out 5mm only, then slide the hold-open washer up against the body of the closer, to hold the arm into position.

### Step 3:

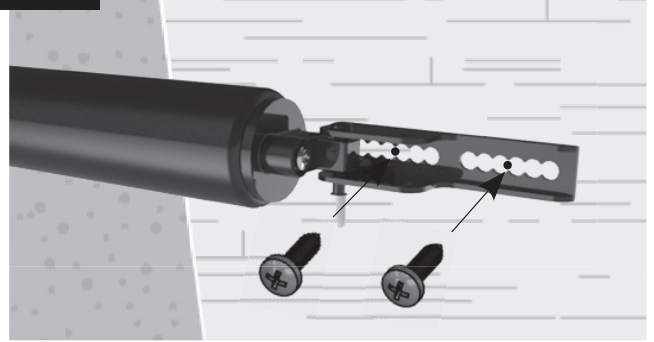

Connect the door closer to the door bracket with the pin & cap provided, as shown. Hold the bracket against the closed door; and ensuring the door closer is level, mark and pilot drill the two fixing holes. Fix the bracket to the door with the two short screws provided. Operate the door to release tension and roll back the hold-open washer, past the crimp in the rod, to disengage the hold-open function.

### Step 4:

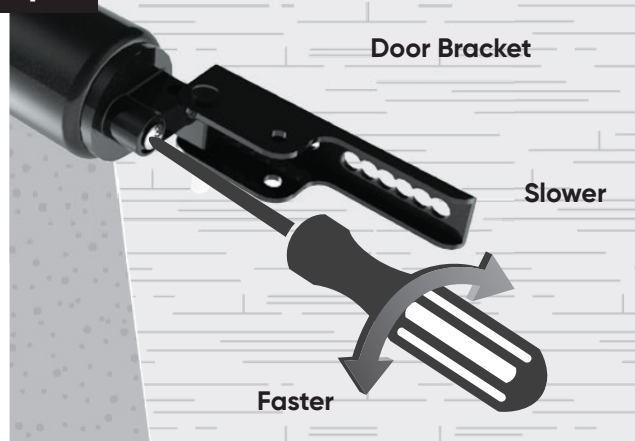

To adjust the closing speed, turn the screw clockwise to slow and anti-clockwise to speed up the close. It may be necessary, within a week or so, to readjust the closing speed after the unit has settled in.

### Holding The Door Open:

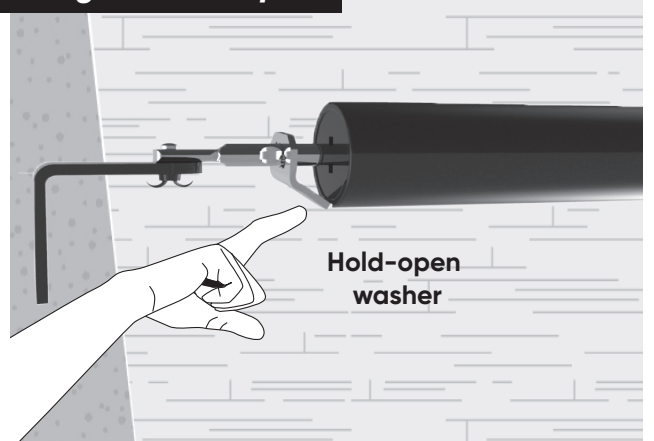

Open the door and remove the spacer tool. Test the door closing speed. Use spacer tool on the valve screw to adjust the door closing speed. Deform split pin with spacer tool.