

Parts list for the kit:

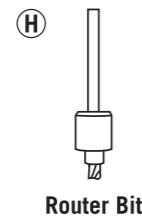

Installation instructions:

Step 1:
Draw a line down the centre of the door edge.

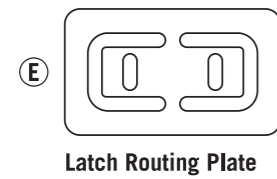
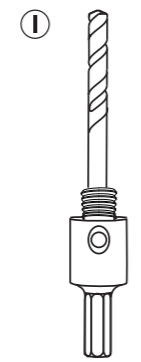
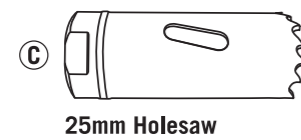
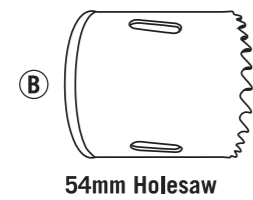
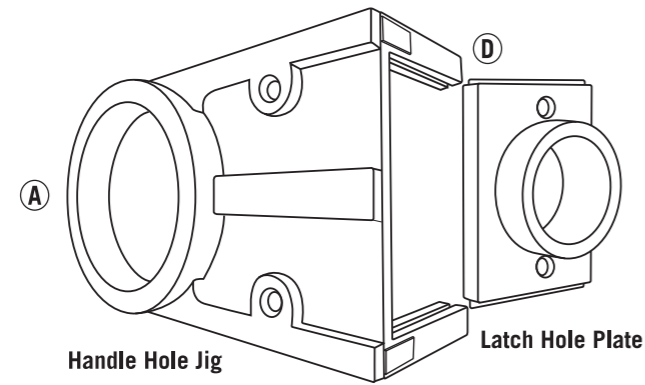
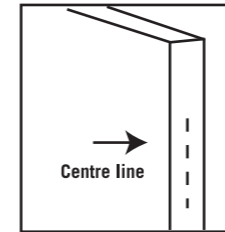

Step 2:
Mark the height of your latch - allowing for any specification from the door manufacturer.

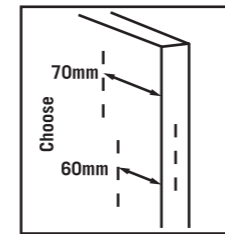

Step 3:
Install the Latch Hole Plate (D) on the centre line, using the screw supplied with your door handles. Install plate flat side against door - to suit handles with 60mm backset. Install plate raised side against door - to suit handles with 70mm backset. Refer diagrams below.

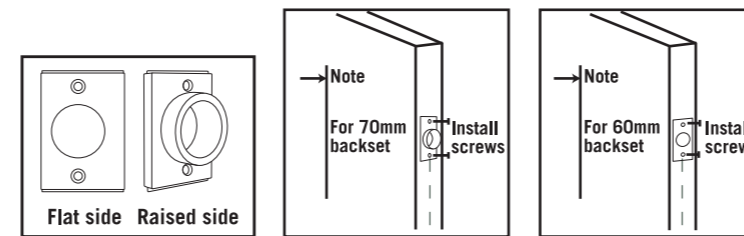

Step 4:
Install the Handle Hole Jig (A) onto the face of the door, by sliding it into the Latch Hole Plate (D).
Note: Do not use the fixing holes to hold this in. These will mark the face of the door and should only be used if a more secure hold is required.

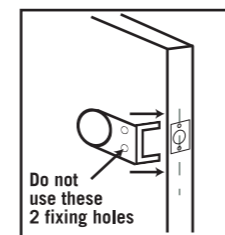

Step 5:
Assemble 54mm Holesaw (B) with Mandrel (I) using Arbor Adapter (F) and Holesaw Arbor Washer (G).
Align 54mm Holesaw (B) with affixed Handle Hole Jig (A) and drill out handle hole.
Tip: For a perfect finish, stop drilling once tip of centre drill (Mandrel) pierces opposite side of door.
Finish drilling handle hole from the opposite side of door.

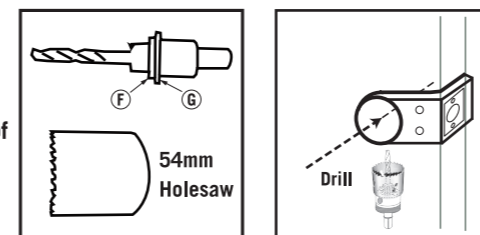

Step 6:
Assemble 25mm Holesaw (C) with Mandrel (I).
Note: Arbor Adaptor (F) and Holesaw Arbor Washer (G) not required.
Align 25mm Holesaw (C) with affixed Latch Hole Plate (D) and drill out latch hole.

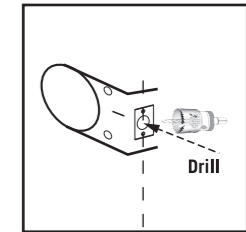
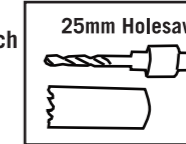

Step 7:
Remove Handle Hole Jig (A) and Latch Hole Plate (D).

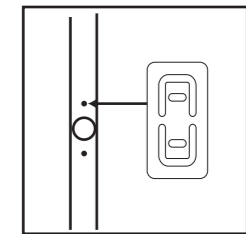

Step 8:
Attach Latch Routing Plate (E) to the latch side of the door by aligning with screw holes. Gently tap with a Hammer (not included) to affix to door.

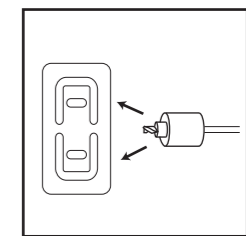

Step 9:
Using the Router Bit (H) with Drill, route out template.

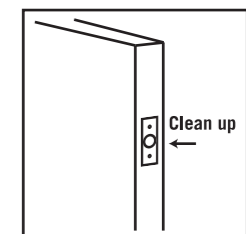

Step 10:
Remove Latch Routing Plate (E) and clean up area with a chisel (not included).

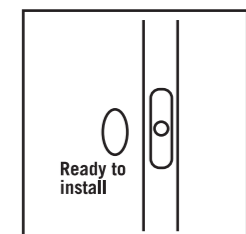

Door handle should now be ready to install.
Door handle not included.
Note:
Suitable for all doors with 60mm & 70mm backsets.

SIZE:405x210mm