

Easy Fit Fly Screen Window Kit

INSTALLATION INSTRUCTIONS



PRODUCT CODE:

Black #7025

**Installation
Video**



For more information visit: permastik.com/help
Save instructions for future reference.

PARTS LIST

PART	DESCRIPTION	QTY
A.	Long Aluminium Profiles	x2
B.	Short Aluminium Profiles	x2
C.	Allen Key	x1
D.	Spline	x1
E.	Fly Screen Mesh	x1
F.	Spline Tool	x1
G.	Adhesive Mounting Clips	x4
H.	Mounting Spring Clips	x2
I.	Handles	x2

(A)



(B)



(C)



(D)



(E)



(F)



(G)



(H)



(I)



If any parts are missing do not attempt to use your Easy Fit Fly Screen Kit.
 Please contact after sales support to obtain replacements.
 Only use parts supplied by the manufacturer with your Easy Fit Fly Screen Kit.

PARTS ASSEMBLY

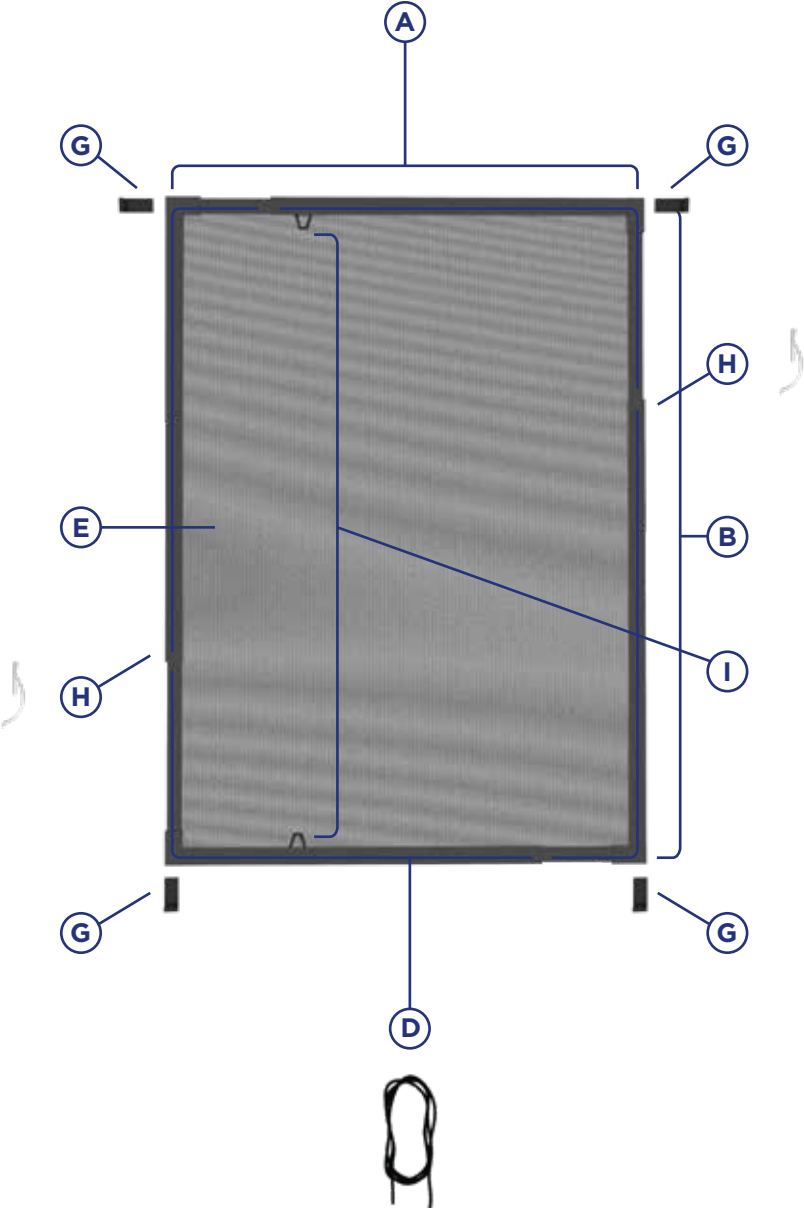

INSTALLATION

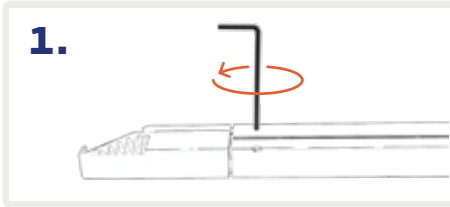

1. **LOOSEN** the grub screw on each profile.

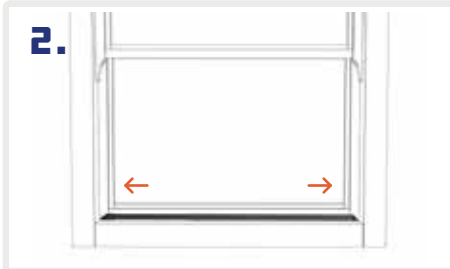

2. **HOLD** a Long Profile up against the window and expand it to match the long side of your window. Then tighten the grub screw to secure it in place.

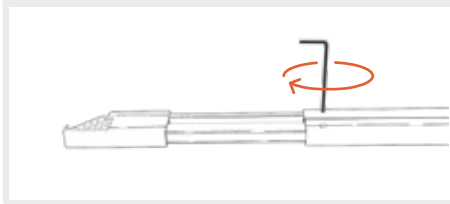

REPEAT this process with one of the Short Profiles.

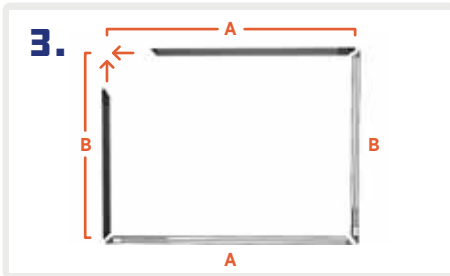

3. **LENGTHEN** the remaining two Aluminium Profiles to match the adjacent side. ($A=A + B=B$)

TIGHTEN the grub screws to secure them in place.



4. **ALIGN** and **CLIP** together the four Aluminium Profiles to form a rectangle.



5. **PLACE** handles in the channels of opposing Profiles.

INSTALLATION

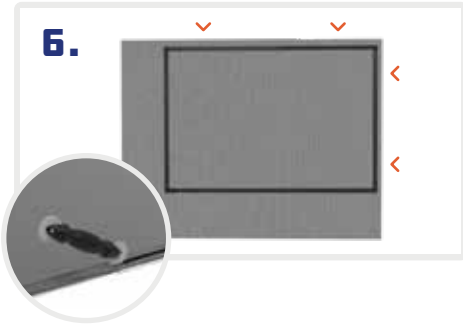

6. LAY the Fly Screen over the frame.
POSITION two edges overhanging the frame by 30mm.
PRESS the Fly Screen Mesh into the channel with Spline Tool to make a groove.

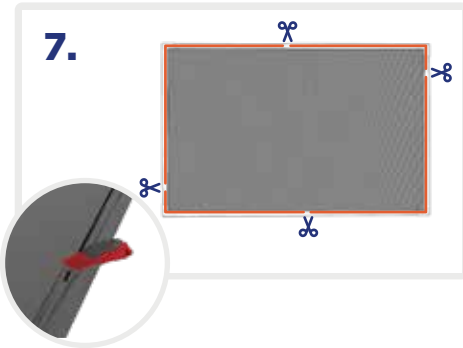

7. USE the concave end of the Spline Roller to press Spline firmly into track, roll along track pushing the Spline into place and securing the Mesh beneath it.

TIP: Start at the middle joints and cut the spline at the next middle joint. Stretch spline as you roll to make it easier to insert.

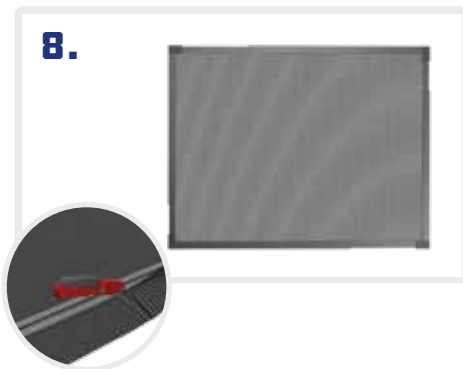

8. TRIM the excess Mesh using a Utility Knife from around the edges of the frame.

MOUNTING

Mounting Option 1 (Adhesive Clips)

For mounting flush on walls.

1. HOLD the frame up against the wall, lightly mark each corner with a pencil. Remove the backing and firmly press each Adhesive Clip onto the wall in the configuration shown. Allow 1 Hour for the adhesive to bond, before placing the frame back on the clips.

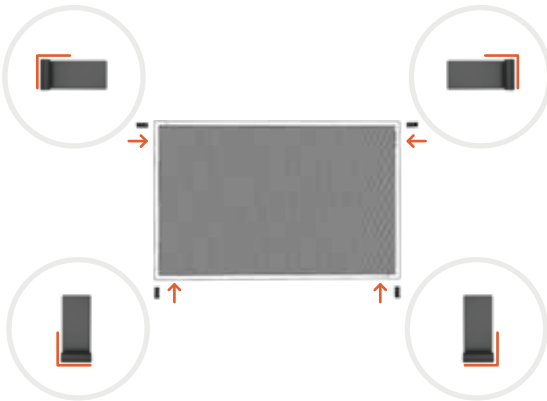
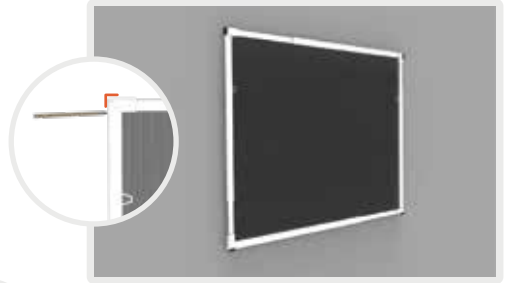

Removal Instructions

Use dental floss to gently cut through substrate and remove the object from the surface.

Stretch or peel off the remain adhesive, use an adhesive solvent for best results.

TO REMOVE the frame from the Adhesive Clips.

- 1. LIFT** the frame up and off the two bottom clips.
- 2. ANGLE** the bottom of the frame out.
- 3. SLIDE** down to clear the top two clips.

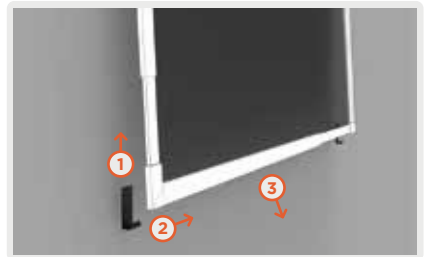

Mounting Option 2 (Spring Clips).

For mounting inside window frame.

Insert the two Spring Clips into the middle join on both top and bottom. Press down the spring clips and insert Frame into the window frame, insert top first followed by bottom.

