

2 PCS

HÄFELE

# HÄFELE 105° HINGE

Full Overlay - Clip On

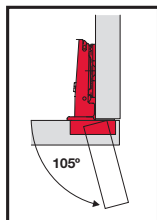

## Drilling Instructions

Hinge Cup (Door)

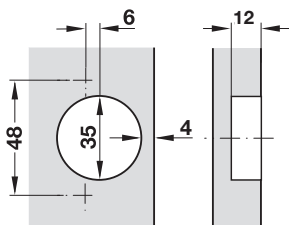

## Mounting Instructions

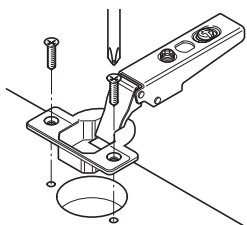

Mount Plate (Cabinet Side)

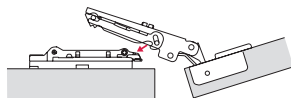
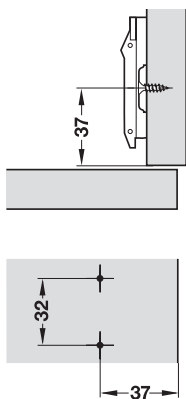

Join the two points marked by an arrow.

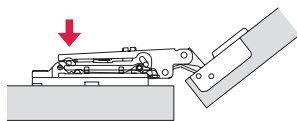

Apply light pressure.

## Adjusting the Door

### Depth adjustment of door with Häfele mounting plates.

With the Häfele mounting plates with quick fixing system, a depth adjustment of the door from  $-0.6$  mm up to  $+3$  mm is possible via eccentric.

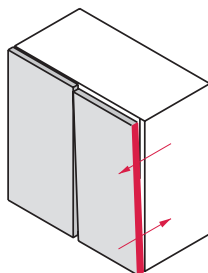
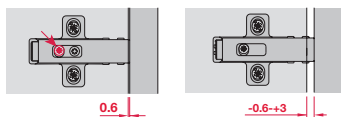

### Height adjustment of door with Häfele mounting plates with slot.

Height adjustment of door of  $\pm 2$  mm is possible by loosening the two fixing screws. The slots allow the mounting plates to slide in both directions. Afterwards the screws must be re-tightened.

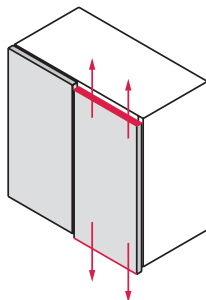
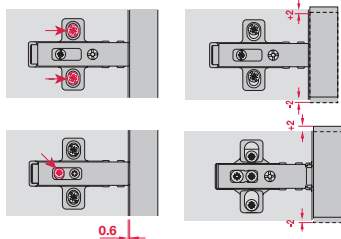

### Lateral adjustment of door with Häfele concealed hinges.

The adjusting screw produces the lateral travel of the hinge arm from  $-2$  mm up to  $+2$  mm.

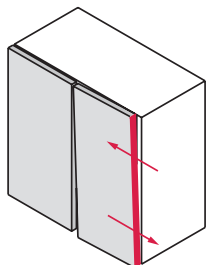
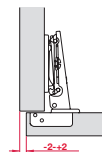

# HÄFELE

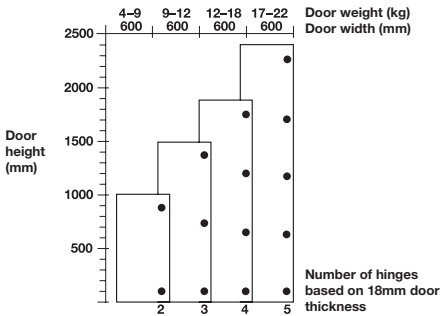

#### Tools Required:

- > 35mm Ø Drill Bit & Template Kit
- > 2mm Ø Drill Bit
- > Pencil
- > Power Drill
- > No 2 Pozidrive Screwdriver / Screw Bit

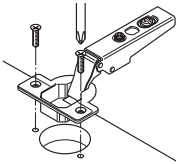

#### Screw fixing

Cup fixed with screws (countersunk head).

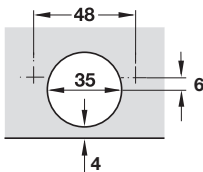

Hinge Drilling Pattern

MADE IN CHINA



HÄFELE AUSTRALIA PTY. LTD  
ARTICLE # 483.02.427

8 MONTEREY RD DANDENONG VIC 3175  
730.83.655