

## EASY INSTALLATION

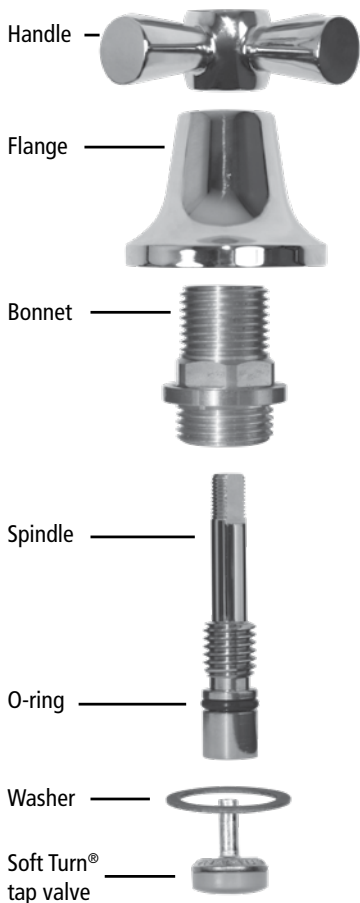

1. Turn off water at mains.
2. Turn tap handle to full open position.
3. Remove tap handle & flange; unscrew & remove spindle & bonnet assembly.
4. Replace tap valve & spindle assembly.
5. Reassemble tap handle.
6. Turn on water supply & inspect for leaks.



### HANDY HINT

Apply FIX-A-TAP<sup>®</sup> lubricant to the tap spindle & o-ring (Product #217271).



### PlumbConnect<sup>®</sup> Plumbers Registry

We recommend installation by a licensed plumber. Find a plumber in your area via the QR code.