

Introduction

The **WX8 Wi-Fi Irrigation Controller** allows anyone with a smartphone and Wi-Fi access to control their home irrigation from anywhere on the globe. Each solenoid is connected to the **WX8** via an individual cable. To complete the electrical circuit, a **COMMON** wire runs from the **WX8** to all of your valves. To open a valve (or water a **ZONE**), the **WX8** sends an electric current to lift a plunger in the solenoid coil. After the **RUN TIME** has expired, the electric current is discontinued and the valve closes. The **WX8** will then automatically open the next valve in the sequence, continuing this way until all allocated **ZONES** have been watered. The **WX8** provides 3 **START** times where **ZONES** can be allocated to each **START**. In addition, **Holman Home** provides the ability to setup **TAP-TO-RUN** watering scenes and **AUTOMATION** watering scenes for your **STARTS** and **ZONES**.

Controller Setup

1

DOWNLOAD AND INSTALL HOLMAN HOME

- Download **Holman Home** onto your mobile device via the **App Store** or **Google Play**
 - Download on the App Store
 - GET IT ON Google Play
- Open **Holman Home** on your mobile device
 - You may be prompted to allow notifications—**Holman Home** will still work if you choose not to
- Tap **SIGN UP**
- Read our Privacy Policy and tap **AGREE** if you wish to proceed
- Follow the prompts to register a **Holman Home** account with your email or mobile number
 - Ensure your country details are correct at this stage
 - You may be prompted to allow **Holman Home** to access your location. This allows the app to show weather information. **Holman Home** will still work if you choose not to allow this
 - The home screen should now appear and you should be able to add devices to your **Holman Home**



2

CONNECT YOUR WX8 TO HOLMAN HOME

- Plug in your **WX8** to a power source near your home Wi-Fi router
 - This is only temporary for the setup process. See **Mounting the Unit** below for mounting your **WX8** to a permanent position
- Using **Holman Home**, tap **ADD DEVICE** on the home screen
- Follow the prompts to continue adding your **WX8** to **Holman Home**
- If connection is successful, the **AP** light will turn **BLUE** and your **WX8** will be available on the home screen
- Turn the **MAIN DIAL** to **OFF**
- Unplug your **WX8** and move to your planned mounting location
- Plug your **WX8** into the nearest power source. After the **AP** light turns back to **BLUE**, turn the **MAIN DIAL** to **RUN**
- Install a 9V battery. See 9V Battery below for more information

AP LED INDICATORS

- BLUE:** Your **WX8** is connected to **Holman Home**. Turn the **MAIN DIAL** to **RUN**
- OFF:** Check your router as you cannot control watering with **Holman Home**. See **WX8 Manual** for more info
- RED:** Your **WX8** cannot connect to the cloud server. Check your internet connection. See **WX8 Manual** for more info

ZONE LED INDICATORS

- BLUE:** This zone is currently watering
- BLUE CHASING AROUND MAIN DIAL:** Mains power source is connected and the 9V battery has enough power
- RED CHASING AROUND MAIN DIAL:** Mains power source is connected but 9V battery needs to be replaced

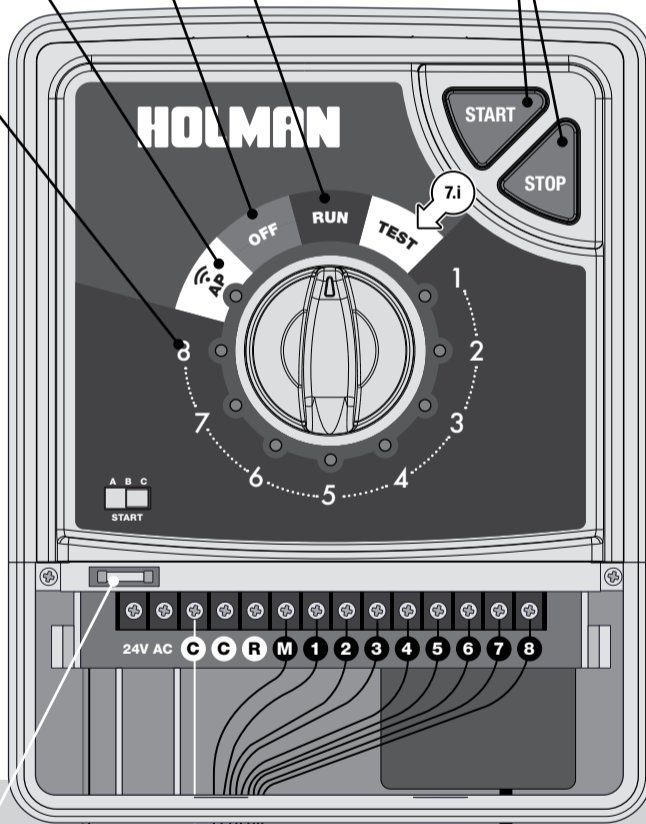
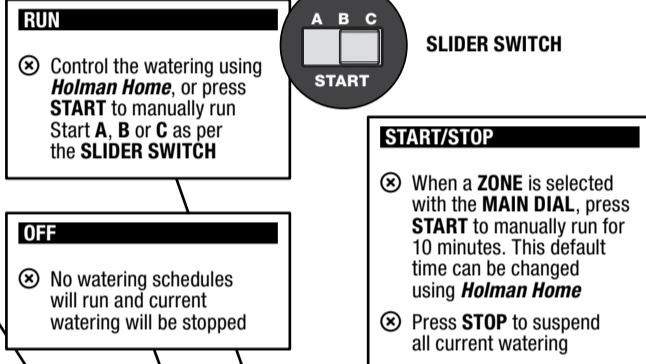

8

FINALISING SETUP

- If required, set up your **EVIE Sensor** or third party rain sensor
- Using **Holman Home**, set up **START** times **A, B** and **C** as per your watering requirements. Also feel free to change the default manual run time for each **ZONE** as needed
- If necessary, change the name of your **WX8** within **Holman Home**. This can make your **WX8** easier to use with voice commands through **Google Assistant** and **Amazon Alexa**
- If connecting to **Google Assistant** or **Amazon Alexa**, use **Holman Home** to set up scenarios for each **ZONE** and **START**

7

SYSTEM TEST

- To run a system test, turn the **MAIN DIAL** to **TEST** and press **START**. Zones with start times set on **A, B** or **C** will run for 2 minutes in sequential order. Press **START** again to skip a zone in the testing order
 - This is to ensure unconnected zones don't attempt to run against a closed head, damaging the pump

6

ZONE SETUP

- Using **Holman Home**, set up **START A** to include all connected **ZONES**, ensuring a **RUN TIME** is allocated to each one

FUSE

- Use only 1 amp fuse M-205

9V BATTERY

- Install a 9V battery so operational integrity of your **WX8** is maintained during Wi-Fi disconnections and power outages
- This battery should be replaced annually



Installation and Wiring

3

MOUNTING THE UNIT

- Position the unit in a place that is convenient for valve wiring, near a power source and within range of your Wi-Fi network
 - Install near a 240V AC outlet
 - We recommend mounting the unit at eye level
 - Try to avoid areas exposed to rain or prone to flooding or heavy water
- Drive a #8 screw into the wall, leaving approx. 4mm exposed. Use a toggle bolt or masonry plug if necessary
- Hang the unit from the key at the back, ensuring it is properly seated
- Optional: Remove the terminal cover to add additional screws through the holes in the lower corners for extra stability

4

FIELD WIRING

- Strip approx. 6mm of insulation and place this under the loosened screw, tighten gently and check the cable is firmly held
 - Ensure terminal block screws are loosened sufficiently to permit easy access for wire ends. Insert stripped wire ends into the clamp aperture and tighten screws
 - Do not over tighten as this may damage the terminal block
 - Connect one cable from the terminals to each solenoid valve
 - A maximum of 2 solenoid valves can be run off each output
 - Complete the circuit by looping a common cable to all valves and connecting to the **COMMON (C)** terminal
- If your water is being supplied directly from the main water supply, it is recommended to install an approved **MASTER VALVE**. This is connected to the **COMMON (C)** and **MASTER VALVE (M)** terminals

5

POWER SUPPLY

- This unit runs off a 240V 50/60Hz single phase outlet, drawing 30VA at 240V AC
- Internal transformer:** Reduces 240V AC to extra low voltage supply of 24V AC
 - Fully compliant with AS/NZS 61558-2-6
 - 30VA low energy, high efficiency toroidal transformer for long life performance
 - Input:** 240V AC 50/60Hz
 - Output:** 24AC, max. 1 amp
 - To solenoid valves:** 24V AC 50/60Hz. 0.5 amp max (up to 2 valves per zone)
 - To master/pump:** 24V AC 0.25, amp max
 - Transformer and fuse capacity must be compatible with output requirements
 - Overload protection:** Standard 20mm 1 amp fuse with faulty station skip function
 - Output circuits should be installed and protected in accordance with wiring rules
 - Avoid connecting to a 240V AC supply which is also supplying motors (i.e. pumps, refrigerators, etc.)

ELECTRICAL CONNECTION

- Installation must be carried out in accordance with all Local, State and Federal codes
- Disconnect all 240V AC power before commencing any field wiring or valve connection

ZONE 1 LOCATION:

ZONE 3 LOCATION:

ZONE 5 LOCATION:

ZONE 7 LOCATION:

ZONE 2 LOCATION:

ZONE 4 LOCATION:

ZONE 6 LOCATION:

ZONE 8 LOCATION: