

Instruction

1. Bill of fittings

A	B	C	D	E
1. Screw for fastening the out door 2. Size : M8*30 3. Optional 	1. Screw for fastening the hanging plate and side plate 2. Size : M8*65(1-2HP) Size : M8*68(2-3HP) 	1. Anti-vibration to mouths 4 pcs 2. Size : 40*40*8mm 3. Optional 	1. Screw for fastening to the wall (1-2HP:800*450*350mm) (2-3HP:850*550*450mm) 2. Size : M10*60(Tapping screw) M14*75(Expansion rubber plug) 	1. Arm lock 2. 2 pcs 3. Screw for fastening the fixing metal 2pcs 4. Size : M8*30 

- A.** Fasten crossbar to the wall **B.** Slide arms into the crossbar **C.** Slide arms locks into the crossbar **D.** Insert fastener into each arm lock, do not tighten yet

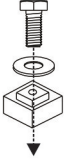
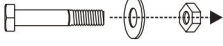
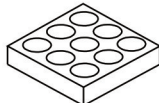
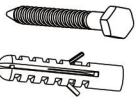
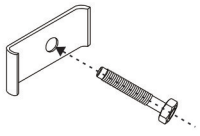
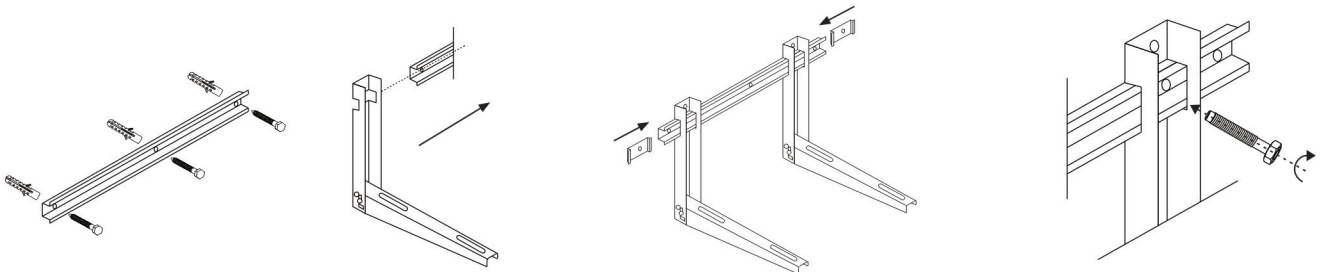

- E.** Adjust arms to suit air conditioner and tighten the fasteners **F.** Alternative fitment method **G.** Unfold the arms down, tighten hinge bolts, and affix mounting assembly

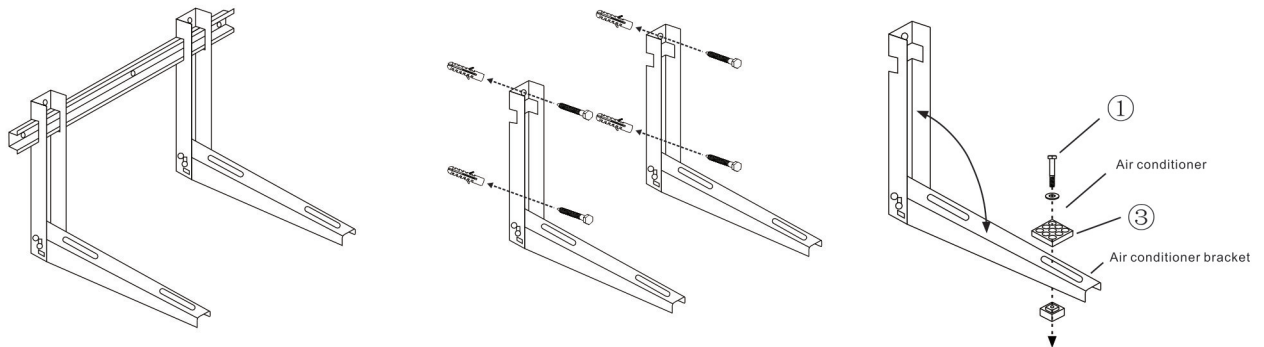

SIZES



Match A/C	Unit	A	B	C	D	E
1-2HP	mm	450	105	184	74	15
2-3HP	mm	550	105	235	95	15

- Note :
- 1.Ensure that the wall bracket is mounted properly to handle applied loads as wall construction may vary.
 - 2.The wall bracket must be securely fixed to wall with all screws fastened tightly.
 - 3.Do not make any modification to bracket assembly or fixings.
 - 4.What mentioned is subject to change without notice.
 - 5.Please check that all screws and bolts are secured tightly before placing the unit on it.